



J a g d I s h

*enjoy fun  
at your home ..*

**Enclave**

BHAGALPUR



*Vikramshila Developers Private Limited*





# About us



Vikramshila Developers Founded over a decades ago and guided by a simple yet profound philosophy: 'Creation, Not Construction', Vikramshila developers Pvt Ltd. is one of the foremost real estate companies in Bihar and Jharkhand with over 1 lacsqft of landmark developments in Bhagalpur and Deoghar.

Vikramshila developers Pvt Ltd has till date built projects in multiple segments such as residential, commercial, retail etc. it offers finest homes, extraordinary in terms of location, engineering, designing and amenities, in prominent cities across the country.

VIKRAMSHILA DEVELOPERS PVT LTD, is the promoters of "JAGDISH ENCLAVE" have established a strong reputation for excellence in design, innovative utilization of space, premium inputs and exceptional workmanship. This project is situated at Prime location Near Chanakya Vihar Colony, Bhagalpur. The company also has an uninterrupted record of completing projects on time and enjoys the confidence of numerous families occupying homes promoted by VIKRAMSHILA DEVELOPERS PVT LTD

"JAGDISH ENCLAVE" is a project that make a choice from elegantly created 2/3 BHK flats. A quality home with premium specifications in a pollution free environment is the dream of every family. Take the first step to moving into a fine home. "JAGDISH ENCLAVE" beautiful planned Residential complex offering 2/3 bedroom deluxe flats for possession, coming up at one of the Bhagalpur most sought after and prestigious location.













# Ground Floor Plan

## AREA STATEMENT

UNIT	TYPE	SUPER BUILTUP
A	3BHK	1772
B	2BHK	1240
C	2BHK	1210
D	3BHK	1524





# Typical 1st-5th Floor Plan

## AREA STATEMENT

UNIT	TYPE	SUPER BUILDUP
A	3BHK	1772
B	2BHK	1240
C	2BHK	1210
D	3BHK	1524
E	3BHK	1280
F	3BHK	1376
G	3BHK	1280
H	3BHK	1498





# Floor Plan



UNIT A

Type : 3 BHK

Area Super built-up : 1772 sqft



UNIT B

Type : 2 BHK

Area Super built-up : 1240 sqft



# Floor Plan

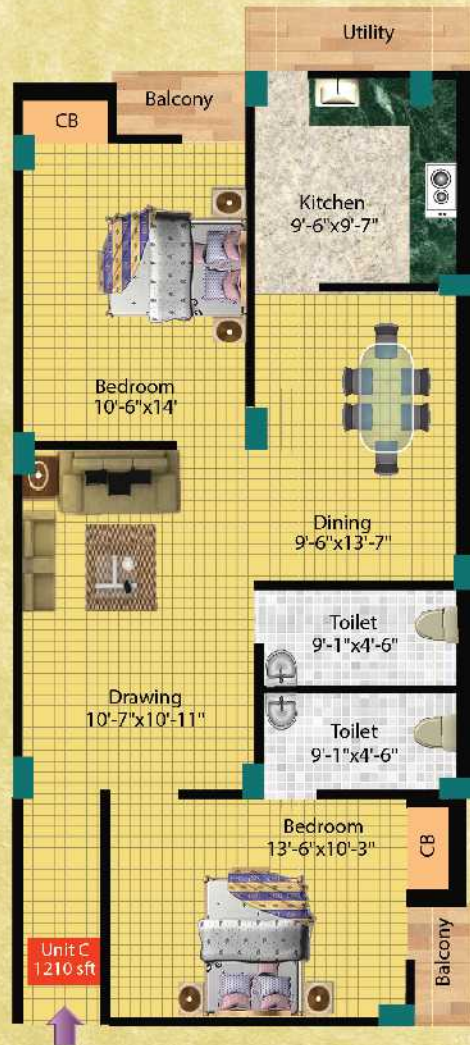

UNIT C

Type : 2 BHK

Area Super built-up : 1210 sqft



UNIT D

Type : 3 BHK

Area Super built-up : 1524 sqft



# Floor Plan



UNIT H

Type : 3 BHK  
Area Super built-up : 1498 sqft

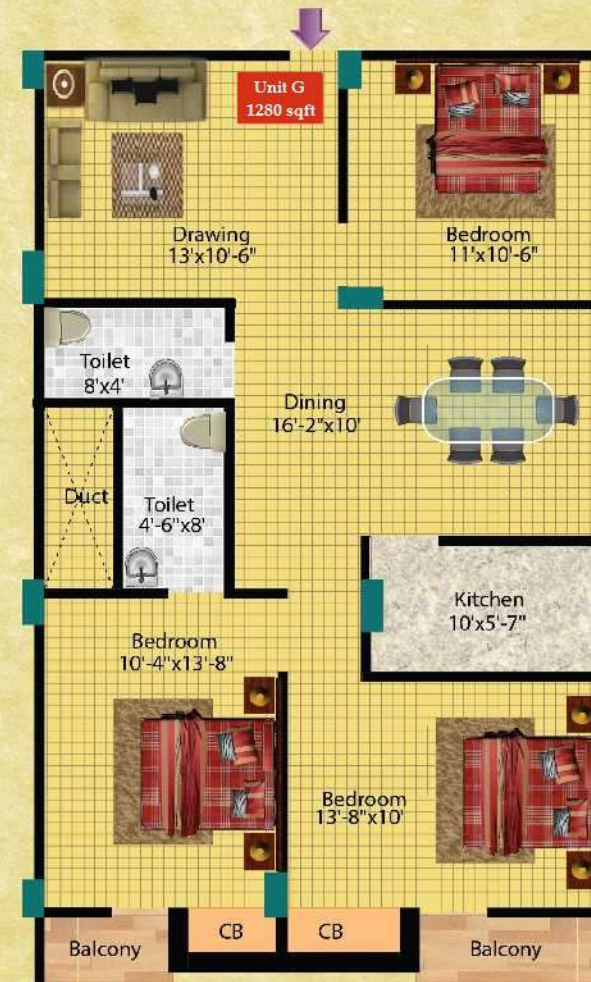

UNIT G

Type : 3 BHK  
Area Super built-up : 1280 sqft



# Floor Plan



UNIT F

Type : 3 BHK

Area Super built-up : 1376 sqft

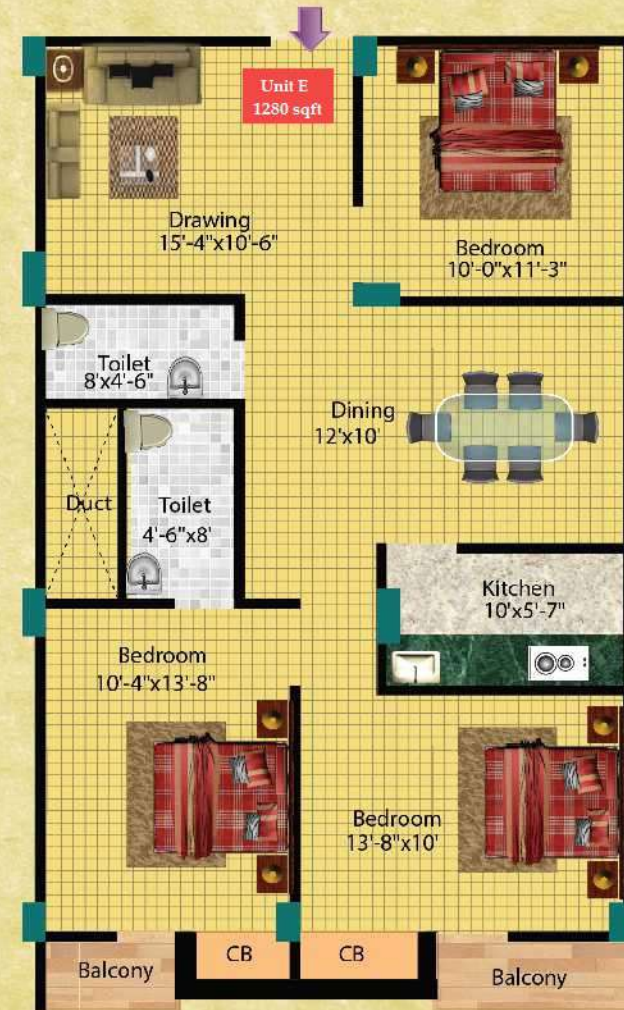

UNIT E

Type : 3 BHK

Area Super built-up : 1280 sqft





DEVPREET VIKRAMSHILA  
Deoghar



SHYAMRI TOWERS  
Bhagalpur



SHIVALAYA  
Jhaushagarih, Deoghar



GANESH ENCLAVE  
Mirzan Hatt, Bhagalpur

## OUR OTHER PROJECTS

MORE THAN 200 HAPPY FAMILY  
RESIDING IN OUR COMPLETED PROJECTS



# AMENITIES



- Elegant designer entrance gate with security cabin
- Community hall with Kitchen(Ground Floor)
- State of art gymnasium (Top Floor)
- Children's play area
- Generator back up for all apartments, lifts and common area
- Earthquake resistance structure areas
- Internal paved road
- Intercom Facility
- Rain water harvesting
- State of manual elevators
- Fire fighting system
- Internal wall finish with smooth gypsum platter
- Ample car and two wheeler parking
- Tiles flooring in common areas
- Separate servant quarters
- 24 hours CCTV surveillance
- Cross Ventilated Flats





# Specification

## STRUCTURE :

- R.C.C. framed structure with cement concrete blocks / brick walls
- Raft Structural Designed Foundation
- Common Area Flooring :
- Upper floor –Vitrified tiles
- Corridors –Vitrified tiles/Marble
- Lift lobby and Ground Floor Lobby –vitrified tiles/marble/parking tiles

## APARTMENT FLOORING :

- Living and Dining –vitrified tiles
- Master bedroom –vitrified tiles
- Other bedroom and kitchen –vitrified tiles
- Balcony and utility –Anti Skid ceramic flooring
- Toilet Flooring - Anti-skid ceramic tiles flooring
- Toilet Walls - Designer concept toilet with 7" high dado tiles

## FITTINGS IN TOILETS:

- Hot and cold mixer with overhead shower in all bathrooms. Hindware/Jaquar/Esco or Equivalent Make
- Quality C P fittings. Hindware/Jaquar /Dazzel/Escoo
- Concealed plumbing CPVC and UPVC fittings
- Provision for exhaust fan in all bathrooms
- ISI quality branded sanitary ware.
- Western style sanitary fittings.

## KITCHEN :

- Black Granite top kitchen platform
- Stainless steel sink
- Cockroach preventing trap
- Points for Aquaguard, Chimney Hood and Water Heater

## UTILITY AREA :

- Inlet and outlet for washing machine and dish washer.

## WINDOW :

- Powder Coated Aluminium sliding/PVC windows in all the rooms

## DOORS:

- Main door –Flush Door with laminate on both side
- Flush doors in all Bedrooms and Bathrooms

## PAINTING AND PUTTY

- Building Exterior finish with Hi Quality Paint finish
- Internal walls and ceiling Finished with double coat white Putty

## ELECTRICAL :

- TV point in the living room and all the bedrooms.
- Fire resistant electrical wires of reputed brand. Havels/Finolex/RR Cable/Anchor or reputed make
- Electrical modular switches of reputed make. Havels/Crabtree/Anchor or any reputed
- One miniature circuit breaker for each room provided
- At all the main distribution box in every apartment.
- Telephone point in living area.
- A/C point in all the bedroom & livings

## INTERCOM FACILITY:

- Intercom facility for each apartment to the security room and other apartment.

## ELEVATOR:

- Manual/Semi automatic KONE or OTIS or equivalent brand make

## BACK-UP GENERATOR:

- Stand-up generator for lights for lights in common area, lifts, pumps.
- Full power back up for each apartment (at extra cost).
- Generator of Mahindra, Kirloskar, Jackson or any other reputed brand make







## Location Map

### KEY DISTANCE

- Vikramshila Setu - 0.5 kms
- Bhagalpur Junction - 6 Kms
- Bhagalpur Zero Mile - 1.5Kms
- Tilkamanjhi - 3 kms
- Ghanta Ghar - 5Kms
- Mount Assisi School - ( 2.5Kms)

CONVENIENCE  
& COMFORT.  
PLUS  
MORE





SITE ADDRESS



Chanakya Vihar Colony, Bhagalpur - 812002

PROJECT BY :



*Vikramshila Developers  
Private Limited*

REGISTERED OFFICE : 8 NAYA PATTI ROAD, PLAZA TOWER COMPLEX BLOCK-D-2, 4TH FLOOR,  
R.N-9 KOLKATA, WEST BENGAL INDIA - 700055  
BHAGALPUR OFFICE : Marwari Tola Lane, Santhalia Market, Bhagalpur-812002  
URL : [www.vikramshiladevelopers.in](http://www.vikramshiladevelopers.in)  
Email : [indiavdpl@gmail.com](mailto:indiavdpl@gmail.com)  
CONTACT  
Bhagalpur Office : 9334383598, 9007114299  
Deoghar Office : 8877222288

Our Architect :- Mr. Santosh Shekhar, Hatia, Ranchi, Mob-9334719264

This is not a legal document. It describes the conceptual plan and intent of the builders. The images and details mentioned in this document are tentative and Subject to change at the sole discretion of the developer and/or architects internal door layout, car parking spaces and other specifications may change without notice.